

September 2024

## 90 Avenue / 50 Street Lane Closures

In support of ongoing construction on the 50 Street Widening and CP Rail Grade Separation project, **upcoming road closures will occur at 90 Avenue in mid/late September** due to ongoing storm sewer work. Work will be staged at the 90 Avenue and 50 Street intersection, beginning with the closure of the westbound lanes (Stage 3), followed by the eastbound lanes (Stage 4). The work is expected to take four weeks. Once completed, the intersection will fully reopen, allowing all turning movements. Efforts are being made to keep as many traffic lanes open as possible during construction. Pedestrian access will remain.

### Stage 3

Starting the week of September 15, westbound lanes and the left turn at 90 Avenue will be closed. Alternate routes include 90A Avenue or 91 Avenue. Suggested detours include Sherwood Park Freeway and 98 Avenue.

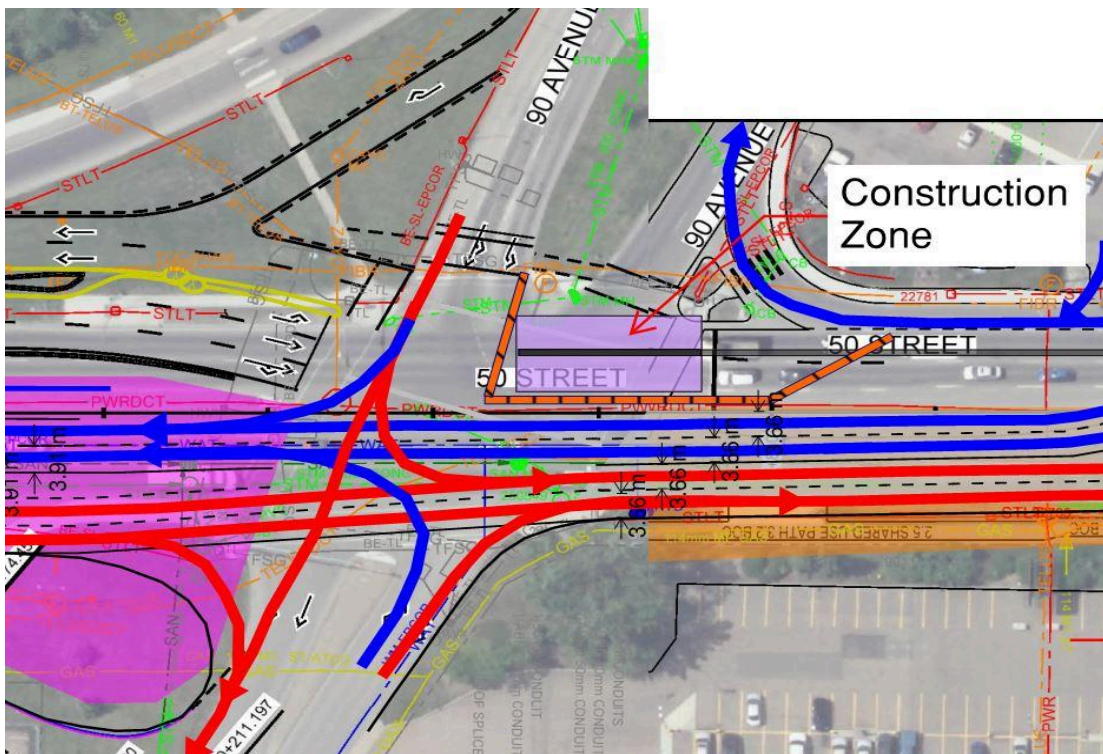

## Stage 4

Starting the week of September 29, construction will continue south, with eastbound lanes on 90 Avenue detoured to the westbound lanes for approximately two weeks. After completing the storm sewer work, the trench will be restored and the intersection will reopen.

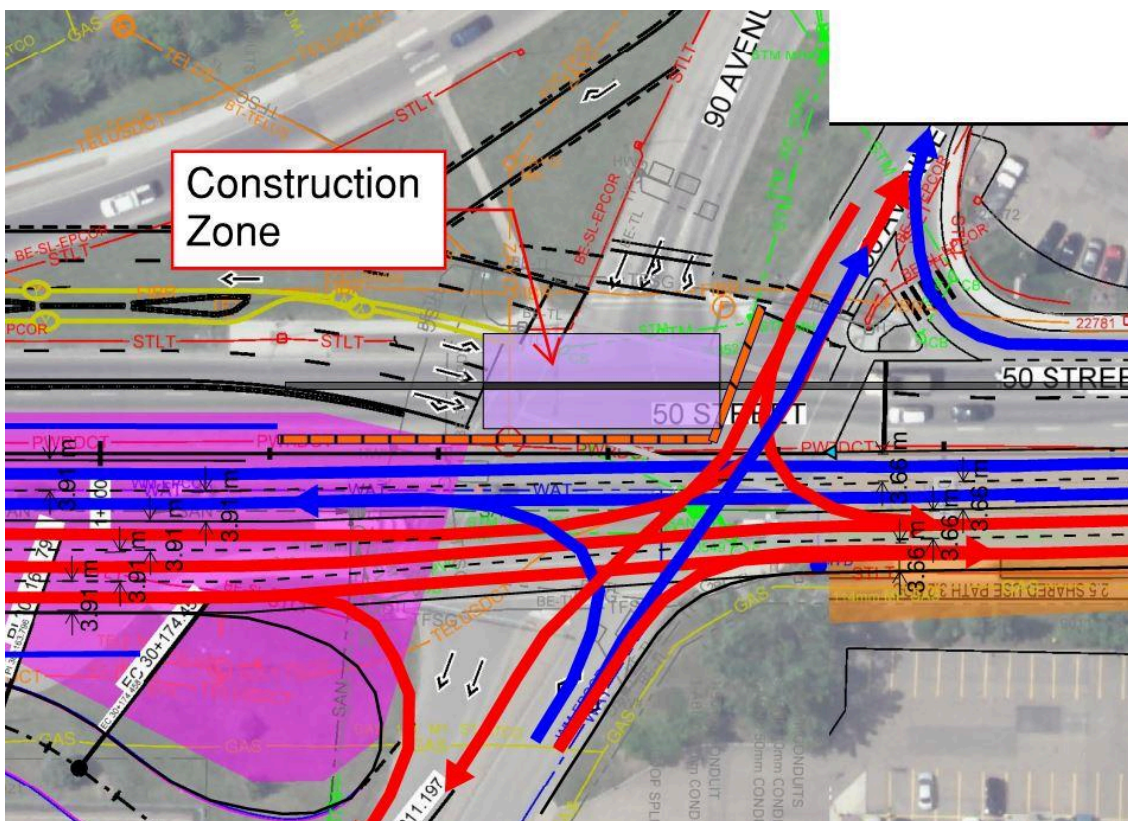

For information about this project, visit [edmonton.ca/50StreetWidening](http://edmonton.ca/50StreetWidening) or contact:

**Malika Ali**

Project Manager, Transportation Infrastructure  
Delivery, City of Edmonton

[malika.ali@edmonton.ca](mailto:malika.ali@edmonton.ca) | 780-690-6055

**Joe Kabarchuk**

Project Manager, Alberco Construction Ltd  
780-267-5816