

Legend

- Load from Above
- 8" CONCRETE
- 2x6 WALL
- 1-1/4" x 11-7/8" x 24" OSB
- TS Flim R22 (1-1/8) 4.5 x 11.875" (S/O)
- NI-20 11.875
- NI-40x 11.875
- NI-80 11.875
- West Fraser 2.0 1.75 X 7.25 (Dropped)
- Nordic Lam 24F-1.9E 1.75 X 11.875 (Dropped)
- Nordic Lam 24F-1.9E 1.75 X 11.875

General Notes

1. Enter floor joist notes here.

Company Information	Drawing Title	Project Address	Date
----------------------------	---------------	-----------------	------

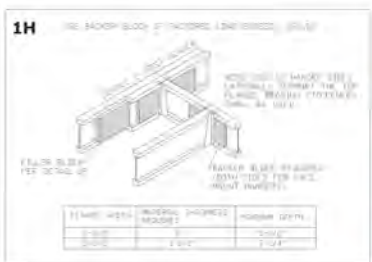
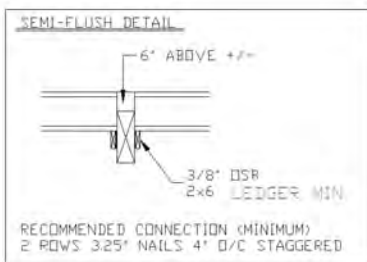

Legend

- Load from Above
- 8" CONCRETE
- 2x6 WALL
- Wall Opening
- 1-1/4" x 11-7/8" x 24' OSB
- TS Rim R22 (1-1/8) 4.5 x 11.875" (S/O)
- TS Rim R16 (1-1/8) 3-1/2 x 11-7/8-12'
- NI-20 11.875
- NI-40x 11.875
- West Fraser 2.0 1.75 X 14 (Dropped)
- West Fraser 2.0 1.75 X 20 (Dropped)
- S-P-F #2 1.5 X 9.25 (Dropped)
- Nordic Lam 24F-1.9E 1.75 X 9.5 (Dropped)
- Nordic Lam 24F-1.9E 1.75 X 11.875
- Nordic Lam 24F-1.9E 1.75 X 14 (Dropped)

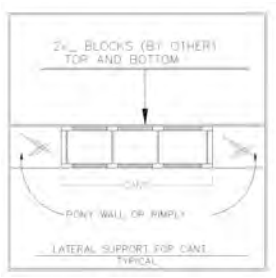
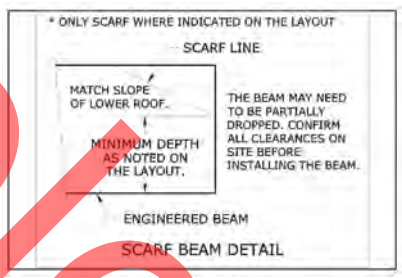

General Notes

1. Enter floor joist notes here.

Company Information	Drawing Title	Project Address
		Date